

FOR LEASE

Building 18, 1110 Middle Head Road
Middle Head, Headland Park, Mosman



*Photo taken prior to installation of fit out





Above: Location images.

Situated amidst 30 hectares of lush natural parkland on the captivating Middle Head peninsula in Mosman, these buildings have been thoughtfully reimagined to preserve their rich historical significance whilst providing inspiring and contemporary spaces.

Spacious and light-filled, the suite provides a versatile canvas for your corporate headquarters, creative studio, health and wellbeing practice or innovative workspace. Step out onto the private deck area, available for non-exclusive use and take in the beautiful vistas and tranquillity of the surrounding environment.

Featuring 3 dedicated office spaces complemented by a shared common workspace or reception/waiting area, this arrangement offers a balanced blend of individual workspaces and collaborative zones. It's a space where history meets modernity, providing an ideal setting for productive endeavours amidst natural beauty and historical charm.

 **Net lettable area**
Suite: 79m² (approx.)

 **Rent**
\$42,926 per annum + outgoings + GST

Enquiries

For further details about this property or to organise an inspection, please contact:

Melanie Rose, Property & Leasing Manager

0409 697 333

melanie.rose@harbourtrust.gov.au

harbourtrust.gov.au/lease



Map legend

 Main walking routes

 Harbour Trust sites

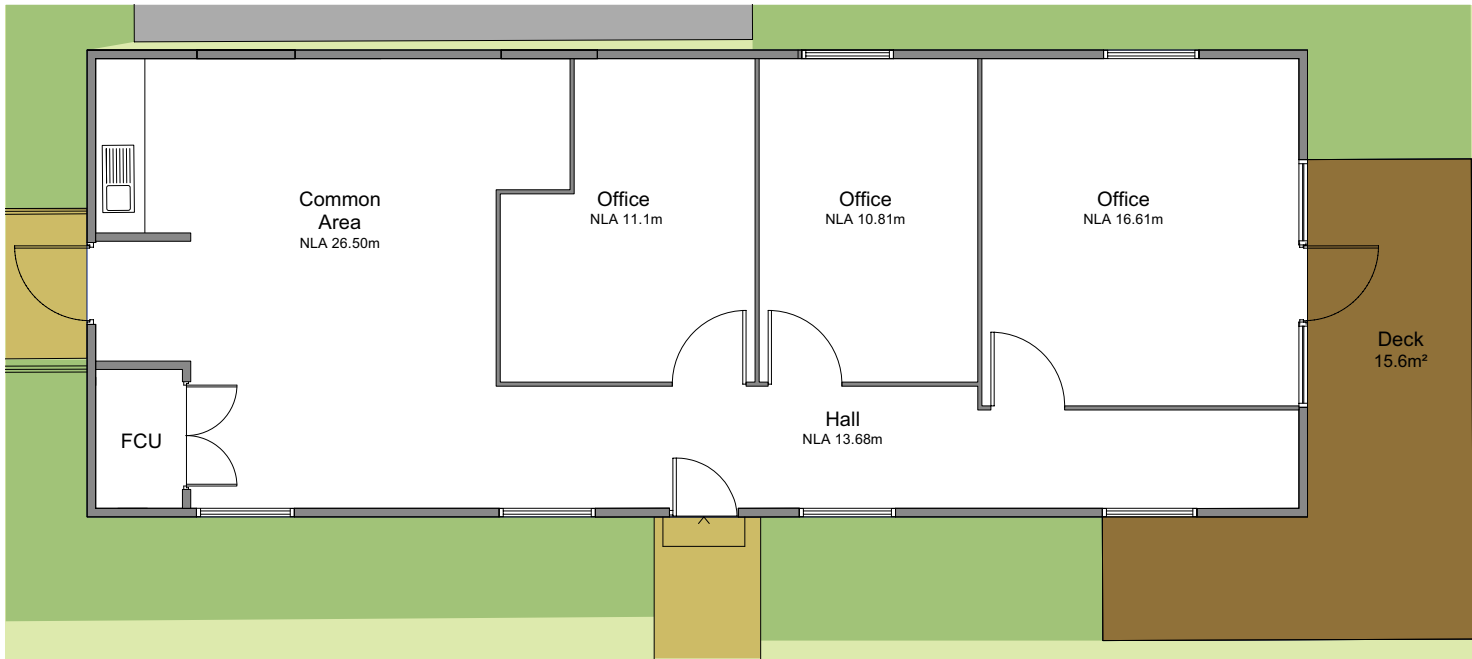

Legend

FCU: Fire Control Unit

Building 18, 1110 Middle Head Road, Middle Head, Headland Park, Mosman