

FOR LEASE

Suite B, Building 32, Suakin Drive
Georges Heights, Headland Park, Mosman



Above: Location image.

Position your business in one of Sydney's most sought-after locations, surrounded by 40 hectares of picturesque parkland. This unique suite offers not only a serene, eco-friendly environment but also supports the conservation of Harbour Trust's protected public lands.

Blending historic charm with modern amenities, this heritage-listed building features a spacious, naturally lit 42sqm shared meeting room, elegant timber floors and the comfort of air conditioning. Shared facilities include a well-equipped kitchen, bathrooms and convenient shower amenities for those seeking a more active, balanced workday. You'll also enjoy access to a beautifully landscaped common courtyard, providing an ideal space for breaks or informal meetings.

Join a vibrant community of creative businesses and enjoy free car and bicycle parking, along with easy access to public transport. With nearby cafes, childcare, and recreational facilities, this location provides everything you need to foster your business growth in a dynamic, connected workspace.



 **Net lettable area**
Suite: 63.56m²

 **Rent**
\$33,650 per annum + outgoings + GST

Enquiries

For further details about this property or to organise an inspection, please contact:

Melanie Rose, Property & Leasing Manager

0409 697 333
melanie.rose@harbourtrust.gov.au

Claire Nolan, Leasing Officer

0448 110 016
claire.nolan@harbourtrust.gov.au

harbourtrust.gov.au/lease

Map legend

 Main walking routes  Harbour Trust sites

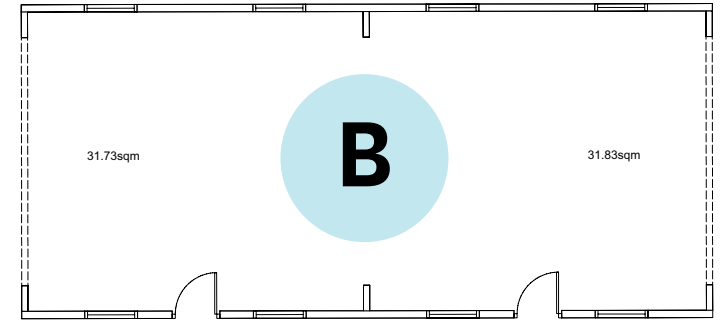
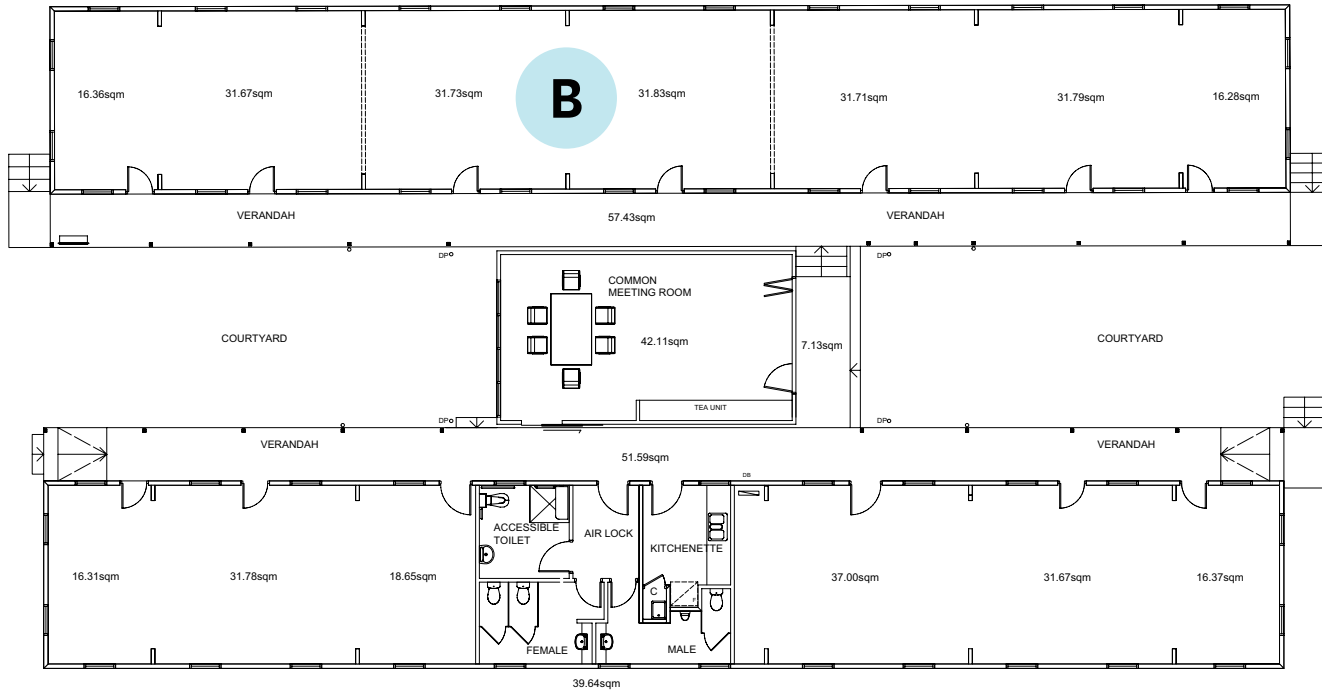

Suite B, Building 32, Suakin Drive, Georges Heights, Headland Park, Mosman