



VENUE GUIDE

# North Head Sanctuary Manly







## ACKNOWLEDGEMENT

The Harbour Trust acknowledges the Traditional Custodians of the lands, waters, and sky of Sydney Harbour, and of the sites under our stewardship: the Borogegal, Birrabirragal, Cammeraygal, Gadigal, Gayamagal, Wallumedegal and Wangal peoples.









## CONTENTS

<b>INTRODUCTION</b>	<b>5</b>	<b>NORTH FORT</b>	<b>14</b>
<b>VENUE SUMMARY</b>	<b>7</b>	BUILDING 239 (ARTILLERY SHED)	15
<b>OVERVIEW AND CONSIDERATIONS</b>	<b>8</b>	BUILDING 238	16
<b>BARRACKS PRECINCT</b>	<b>10</b>	SANCTUARY LAWN – MEMORIAL WALK	17
PARADE GROUND	12		
OLD HOCKEY FIELD	13		

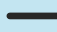

**FAIRFAX WALK AND LOOKOUTS**

-  Main walking routes
-  Secondary walking routes
-  Shared bicycle/pedestrian path
-  Bondi to Manly Walk route
-  Harbour Trust boundary



## INTRODUCTION

**North Head is a place of significance to First Nations peoples. Initial investigation suggests the area was a place of gathering and ritual, with land management of the ecosystem practiced for thousands of years. It was a site of some of the first encounters between Europeans and First Nations peoples from 1788.**

Just a short drive from Manly Beach, North Head Sanctuary is a coastal parkland bordered by dramatic cliffs on the peninsula. North Head Sanctuary is bounded by Sydney Harbour National Park, managed by NSW National Parks and Wildlife Service, and the North Head Wastewater Resource Recovery Facility, managed by Sydney Water.

In 1833, North Head was proclaimed a quarantine station before being used for defensive fortification, training and barracks in the Second World War.

After the Second World War, the School of Artillery opened at North Head. Military personnel lived and trained there from 1946 until 1998, when the school relocated to Puckapunyal, Victoria.

North Head boasts a diversity of native flora and fauna across a range of habitats.

It is home to endangered population of long-nosed bandicoots, once common throughout Sydney. Small populations of formerly locally extinct species including the eastern pygmy possum, brown antechinus and bush rat have been reintroduced to North Head Sanctuary in recent years.







## VENUE SUMMARY

BUILDING	AREA (M <sup>2</sup> )	CAPACITY		SURFACE	POWER	TOILETS	WATER
		STANDING (PAX)	THEATRE STYLE (PAX)				
<b>BARRACKS PRECINCT</b>							
Parade Ground	7,920m <sup>2</sup>	3,000	3,000	Heritage red gravel/clay	✓	✗ Sullage connection available	✗
Old Hockey Field	2,320 m <sup>2</sup>	n/a	n/a	Grass	✓	✗	✗
Green rooms	129.6 m <sup>2</sup>	n/a	n/a	Carpet	✓	✓	✓
<b>NORTH FORT</b>							
Building 238	318.84m <sup>2</sup>	150	75	Concrete	✓	✗	✓
Building 239 (Artillery Shed)	392.15m <sup>2</sup>	200	100	Painted concrete	✓	✗	✓
Sanctuary Lawn	710m <sup>2</sup>	400	300	Grass	✓	✗	✓



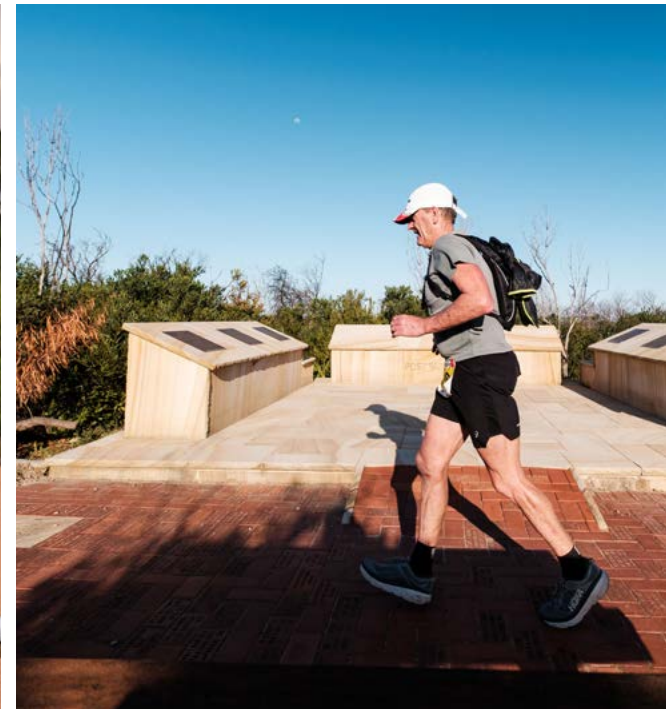

## OVERVIEW AND CONSIDERATIONS

### DRY HIRE

There is no onsite commercial kitchen, event equipment, furniture, or plant equipment. Event infrastructure will need to be brought in.

### ENDANGERED FLORA AND FAUNA

North Head is a refuge for echidnas, reptiles, frogs and more than 100 species of bird. It is also home to an endangered population of long-nosed bandicoots. Environmental impact plan required for large events.

### BUSHFIRE MANAGEMENT

An event specific risk-based bushfire emergency management and evacuation plan, prepared by a qualified consultant, may be required, depending on size and nature of event.

### PUBLIC AMENITIES

Public toilets are onsite, however additional facilities may be required for events (operator to provide and maintain, including cleaning).

### TRANSPORT

**Public:** Access via bus service 161 from Manly Wharf. Only available for small activations. Please note public transport runs a limited service in evenings and on weekends.

**Event:** Private bus service is required for medium and large events to minimise traffic movements onsite.

### WATER

Access to water can be arranged to most locations. Fire hydrants must only be used in emergencies.

### ELECTRICITY

Power is available at all buildings onsite. Limited outdoor power. Generators may be required to supplement needs.

### SECURITY

Onsite rangers and security patrol North Head Sanctuary 24/7 however, additional security will be required to be provided by the successful operator. Ratios of security to patrons will be determined by the liquor permit (if applicable).





### **WASTE MANAGEMENT**

A waste management plan is required under the licence agreement. The Harbour Trust provides the option to utilise our services on a charge back basis.

### **NOISE LIMITATIONS**

A noise management plan may be required depending on activity and to be in line with North Head Sanctuary's noise management plan.

### **PARKING**

Limited car parking available onsite for staff, suppliers and contractors only. Satellite parking and shuttle buses from the Manly town centre should be organised for patrons. A traffic and transport plan, addressing arrangements for deliveries, pedestrian movements and transport for patrons, must be provided prior to bump in.

### **LIQUOR PERMIT**

Permit must be applied through the Harbour Trust and not Independent Liquor & Gaming Authority.

### **GATE OPENING/CLOSING HOURS**

Please check the NSW National Parks and Wildlife Service website for North Head Scenic Drive gate opening and closing hours at [www.nationalparks.nsw.gov.au](http://www.nationalparks.nsw.gov.au)

### **TENANTS**

It is important for the event operator to examine opportunities to consult and engage with existing tenants and, where appropriate, to provide the opportunity for tenants to offer services that organisers would otherwise seek from external sources. By actively involving

tenants in the event planning process, the operator fosters a supportive and inclusive environment, enabling tenants to participate in events in a way that aligns with their businesses and creates valuable opportunities for them.



## BARRACKS PRECINCT | PARADE GROUND, BUILDING 1 (MAIN BARRACKS BUILDING) AND OLD HOCKEY FIELD

### **Built in 1936 for ceremonies and drills, and boasting a distinctive red gravel surface, the Parade Ground is the centrepiece of North Head Sanctuary's Barracks Precinct**

The Barracks Precinct is a collection of Art Deco buildings that occupy a significant place in Australia's military history. After the Second World War, the School of Artillery opened at North Head. Military personnel lived and trained there from 1946 until 1998, when the school relocated to Puckapunyal, Victoria.

### **VENUE SIZE, SCALE AND FREQUENCY LIMITS**

Our venues have unique contexts and characteristics, they are not all suitable for, nor are they equipped to accommodate all types of events and activations. In recognition of the fragile environmental values of North Head, the Harbour Trust's Events and Activation Strategy 2023–2028 limits large and medium events to the Barracks Precinct only.

### **LARGE EVENTS**

Up to 2 events annually

#### **Characterised by:**

- Visitation of up to 3,000 people per event day
- Duration of more than 3 days
- Operations no later than 9pm
- Road closures, traffic/pedestrian control required.

### **MEDIUM EVENTS**

Up to 2 events annually

#### **Characterised by:**

- Visitation of 500 to 2,000 people per event day
- Duration of 3 days or less
- Operations no later than 9pm
- May have some restriction to public access

#### **CONSIDERATIONS**







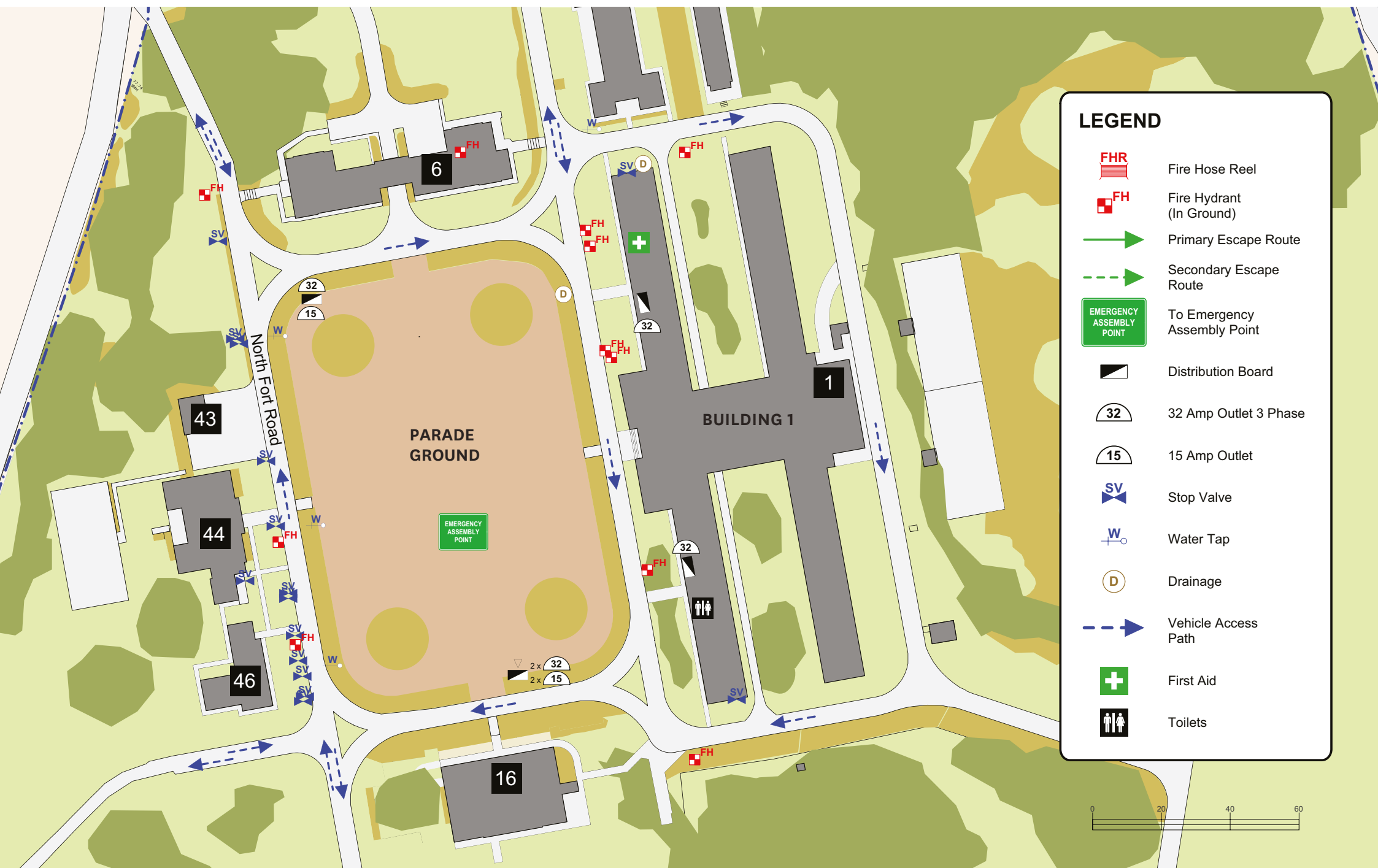





- Heritage considerations means that pegging or excavation into the gravel surface of the Parade Ground is not permitted.
- Protected and endangered flora and fauna
- Proximity to nearby residents and businesses



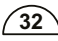
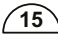

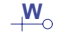

### LEGEND

-  Fire Hose Reel
-  Fire Hydrant (In Ground)
-  Primary Escape Route
-  Secondary Escape Route
-  To Emergency Assembly Point
-  Distribution Board
-  32 Amp Outlet 3 Phase
-  15 Amp Outlet
-  Stop Valve
-  Water Tap
-  Drainage
-  Vehicle Access Path
-  First Aid
-  Toilets

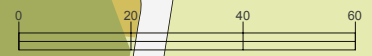



## BARRACKS PRECINCT | PARADE GROUND

Boasting a distinctive red gravel surface, the Parade Ground is the centrepiece of North Head Sanctuary's Barracks Precinct.

### EXAMPLES OF APPROPRIATE USE

Concerts, exhibitions, markets, filming and photography.

### CAPACITY

3,000 pax

### SITE SPECIFICATIONS

**Surface:** Heritage surface (red gravel)

**Toilets:** Located in Building 1

**Power:** 3 x 32amp and 3 x 15amp

**Water:** Water and waste point accessible. Connection to be arranged by the operator.

### GREEN ROOMS

Green room facilities are available in the west wing of Building 1 (Main Barracks Building), in the immediate vicinity of the Parade Ground.

The green room is comprised of 1 x talent lounge, 1 x kitchenette, 1 x event office and separate male and female, 3 x toilets and 3 x showers each. Diagram below.

### SIZE

**Area:** 7,920m<sup>2</sup>

**Dimensions:** 82m x 119m

### VENUE SPECIFIC INFORMATION

Heritage gravel surface

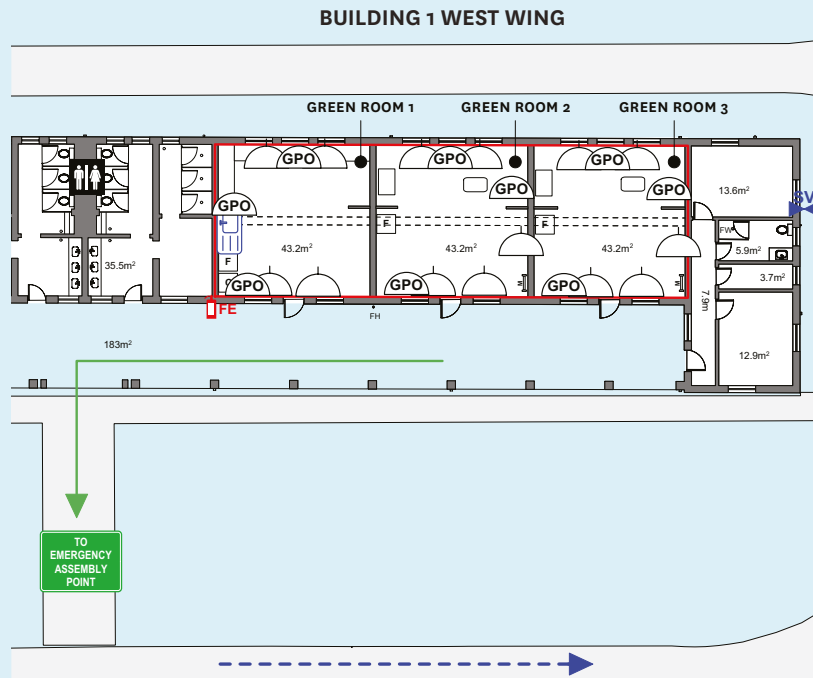

### LEGEND

- Fire Hydrant (In Ground)
- Dry Chemical Powder Fire Extinguisher
- Co<sup>2</sup> Fire Extinguisher
- Primary Escape Route
- Secondary Escape Route
- TO EMERGENCY ASSEMBLY POINT
- Distribution Board
- 32 Amp Outlet 3 Phase
- General Power Outlet
- Light Switch
- Stop Valve
- Sink
- Vehicle Access Path
- Toilets



## BARRACKS PRECINCT | OLD HOCKEY FIELD

The Old Hockey Field was used for recreational activities by the Australian Defence Force.

### EXAMPLES OF APPROPRIATE USE

Concerts, exhibitions, markets, filming and photography.

### CAPACITY

100 pax

### SITE SPECIFICATIONS

**Surface:** Grass

**Toilets:** Located in Building 1

**Power:** Available

**Water:** Available

### SIZE

**Area:** 2,320m<sup>2</sup>

**Dimensions:** 42.2m x 43.19m

### CONSIDERATIONS

- Noise restrictions
- Protected and endangered flora and fauna
- Tenant antennae
- Access to fire hydrant maintained
- Walking paths maintained



### LEGEND

- Fire Hydrant (In Ground)
- Primary Escape Route
- Secondary Escape Route
- Emergency Assembly Point is approximately 300m away on the Parade Ground
- Distribution Board
- 32 Amp Outlet 3 Phase
- 15 Amp Outlet
- 10 Amp Outlet
- Stop Valve
- Water Tap
- Site Area
- Toilets





## NORTH FORT | BUILDING 239 (ARTILLERY SHED), BUILDING 238 AND SANCTUARY LAWN

**North Fort was a part of 300km coastal defence system of Sydney and contributed to the defence of the harbour during the Second World War.**

Hidden by an abundance of native bushland, North Fort and subsequent tunnel system

includes 200 metres of restored tunnels, magazine and shell store, and engine room.

Located at one end of North Fort tunnels is a steep staircase leading to the Engine Room and at the other end, a freshly painted camouflage flooring and gun emplacement.

### CONSIDERATIONS

- Proximity of commercial tenants
- Protected and endangered flora and fauna
- Limited parking
- NSW National Parks and Wildlife Service gate opening and closing hours



## NORTH FORT | BUILDING 239 (ARTILLERY SHED)

The Artillery Shed was an integral part of the School of Artillery and saw frequent use during Second World War.

Also referred to as the 'Hangar', this venue is 5m high and features a large sliding door, which run on end-to-end on steel tracks.

### EXAMPLES OF APPROPRIATE USE

Events, filming and photography, art exhibitions, activations, product launches and team building activities.

### CAPACITY

200 pax standing  
100 pax theatre style

### SITE SPECIFICATIONS

**Surface:** Painted concrete floor

**Toilets:** Public toilets located near the Visitor Centre

**Power:** 10 x 10amp, 6 x 32amp, 1 x PowerLock

**Water:** Available (external)

### SIZE

**Area:** 392.15m<sup>2</sup>

**Internal dimensions:** 22.7m x 17.3m

**Door height clearance:** 5m

**Height clearance:** 5m

### CONSIDERATIONS

Protection of painted cement floor

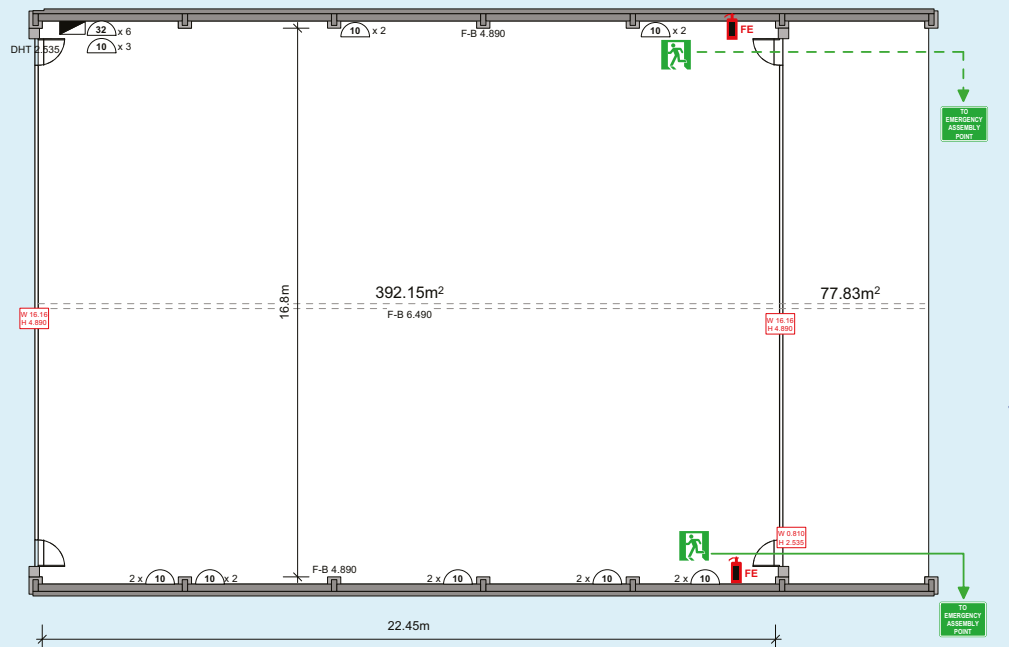

### LEGEND

- FE Co<sup>2</sup> Fire Extinguisher
- Fire Exit
- Primary Escape Route
- Secondary Escape Route
- Emergency Assembly Point is approximately 60m away at the car park lawn, North Fort Road.
- Distribution Board
- 32 Amp - 3 Phase
- 20 Amp Outlet
- 10 Amp Outlet
- Light Switch
- Vehicle Access Path
- Door Width and Height (m)

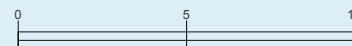



Another shed used as part of the School of Artillery and saw frequent use during Second World War.

**EXAMPLES OF APPROPRIATE USE**

Filming and photography, art exhibitions, smaller activations, unit base, product launches and team building activities.

**CAPACITY**

150 pax standing  
75 pax theatre style

**SITE SPECIFICATIONS**

**Surface:** Concrete floor  
**Toilets:** Public toilets located near the Visitors Centre  
**Power:** 8 x 10amp and 1 x 32amp  
**Water:** Available (external)

**SIZE**

**Area:** 318.84m<sup>2</sup>  
**Internal dimensions:** 22.7m x 17.3m  
**Door height clearance:** 5m  
**Height clearance:** 5m

**CONSIDERATIONS**

Protection of cement floor

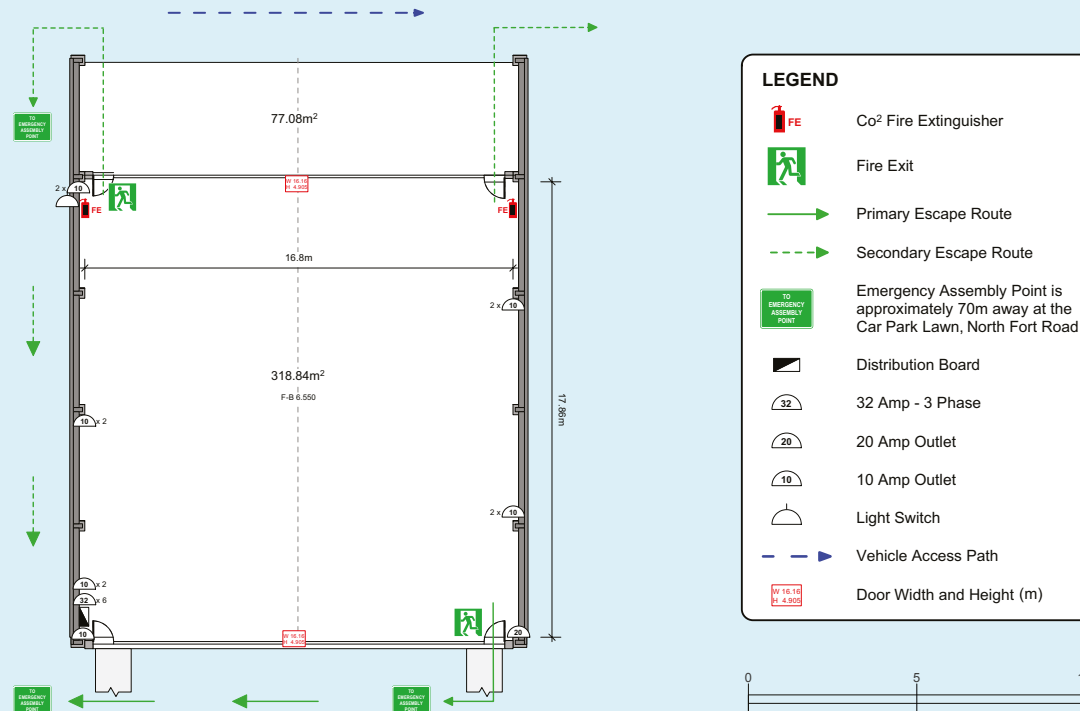

## NORTH FORT | SANCTUARY LAWN – MEMORIAL WALK

Unveiled in 1995, a sandstone lookout known as the Defence of Sydney monument, stands at the southern end of Australia's Memorial Walk.

It pays tribute to Australia's three armed services during the Second World War.

### EXAMPLES OF APPROPRIATE USE

Memorials, wedding ceremonies, filming and photography and activations.

### CAPACITY

400 pax standing  
300 pax theatre style

### SITE SPECIFICATIONS

**Surface:** Grass

**Toilets:** Public toilets located near the Visitor Centre

**Power:** 8 x 10amp and 1 x 32amp

**Water:** Available

### SIZE

**Area:** 710m<sup>2</sup>

**Dimensions:** 22m x 31m

### CONSIDERATIONS

Maintaining pedestrian thoroughfare around the precinct

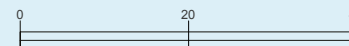
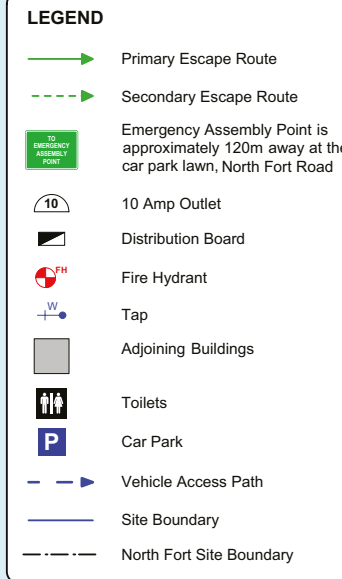
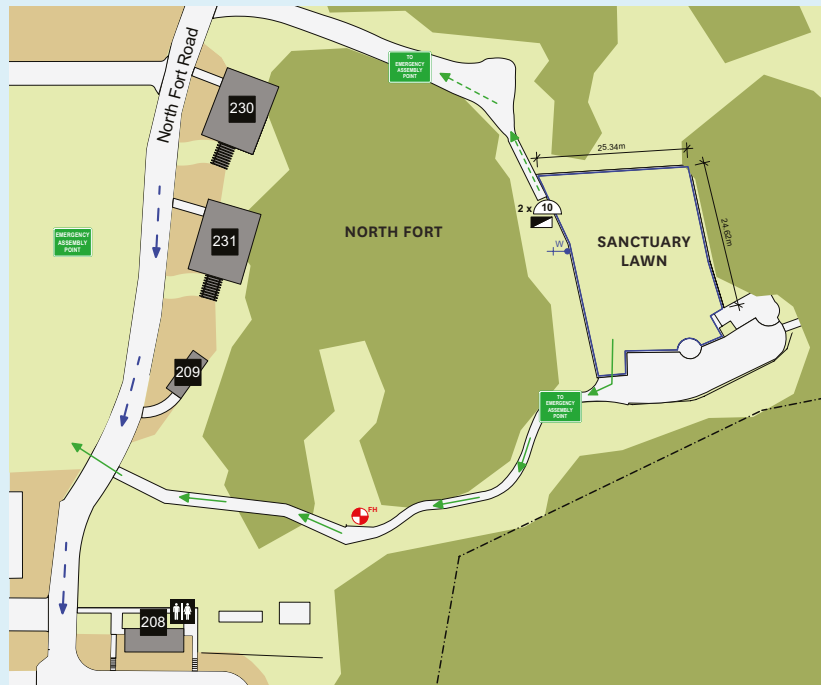



## FOR MORE INFORMATION

Please contact the Harbour Trust Events and Venue team at [licensing@harbourtrust.gov.au](mailto:licensing@harbourtrust.gov.au) or visit [www.harbourtrust.gov.au/venue-hire](http://www.harbourtrust.gov.au/venue-hire) to complete an application form.





Harbour Trust



Australian Government  
Sydney Harbour Federation Trust

 Cockatoo  
Island.



Headland  
Park  
MOSMAN

**NORTHHEAD**  
— SANCTUARY MANLY —

SUB BASE  
PLATYPUS