

FOR LEASE

Suite A, Building 3, Best Avenue
Georges Heights, Headland Park, Mosman



Photos are for representation purposes only

Nestled within the prestigious Georges Heights precinct, this suite is enveloped by 40 hectares of breathtaking parkland. Establish your business in this pristine, eco-conscious setting, where every step forward also contributes directly to the conservation and enrichment of public lands managed by the Harbour Trust.

Experience the allure of this remarkable building, showcasing a generous covered deck, lofty double-height ceilings drenched in natural light, and a spacious 16 square metre meeting room. Enjoy the added comforts of air conditioning, timber floors and shared facilities including a kitchen, bathrooms and shower, all tailored for your convenience. Join a vibrant community of creative enterprises with complimentary car and bicycle parking, and easy access to public transportation. This heritage gem boasts sleek contemporary design and is near cafes, childcare, and recreational amenities, making it the perfect locale for your business aspirations.

 **Net lettable area**
Suite: 93.74m² (approx.)

 **Rent**
\$55,365 per annum + outgoings + GST

Enquiries

For further details about this property or to organise an inspection, please contact:

Melanie Rose, Property & Leasing Manager

0409 697 333

melanie.rose@harbourtrust.gov.au

harbourtrust.gov.au/lease



Map legend

 Main walking routes

 Harbour Trust sites

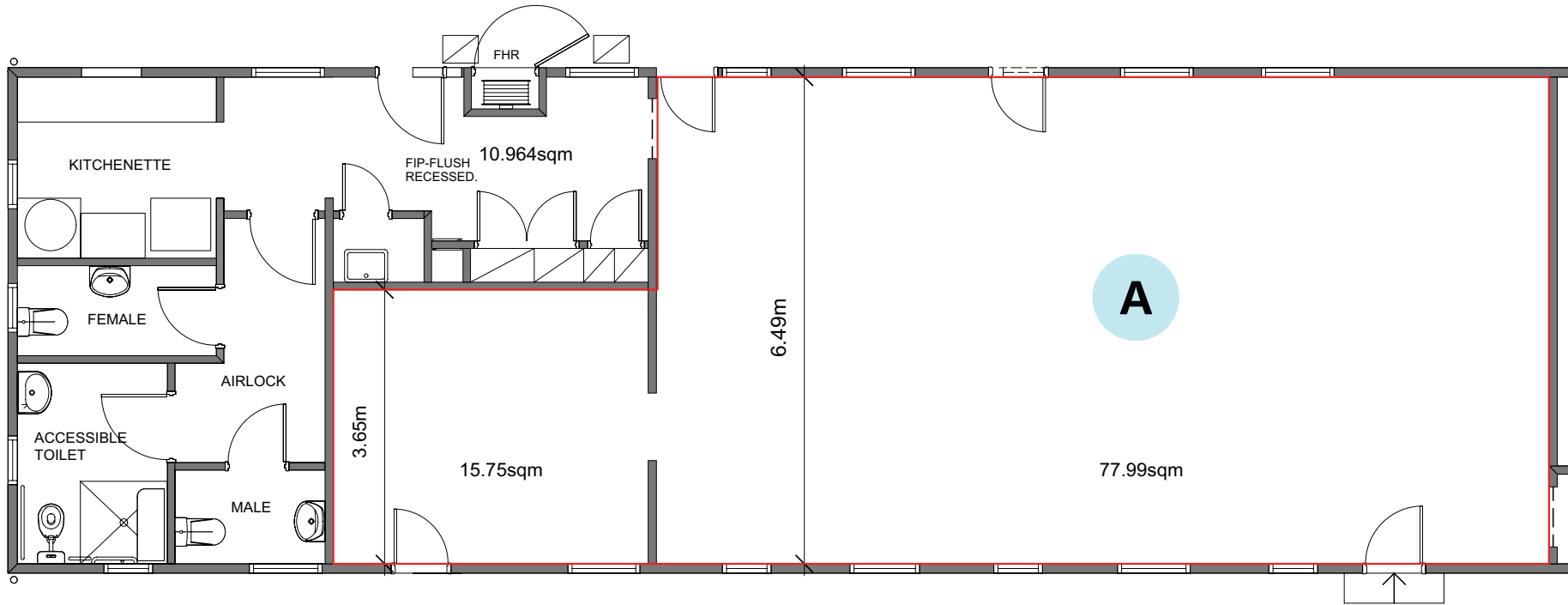

Suite A, Building 3, Best Avenue, Georges Heights, Headland Park, Mosman